

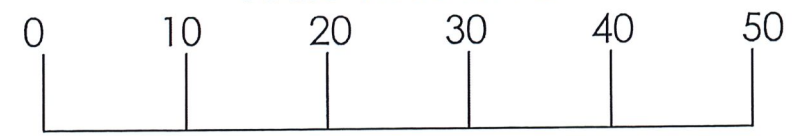



Scale 1:500 at A3



Acland Park  
Stages 10,12&13  
Res.Lots & 8 Multi lots

WD-1970 Sht2 Iss A  
Design-Net Ltd

Accepted  
**Orion**  
*Craig Marshall*  
Craig Marshall  
Oct 29 2020

- Notes:
1. All work to Orion NZ standards.
  2. Developer to complete all trenching & 100mm ducting.
  3. Install Lights to Windsor Dwg. A3-400097.

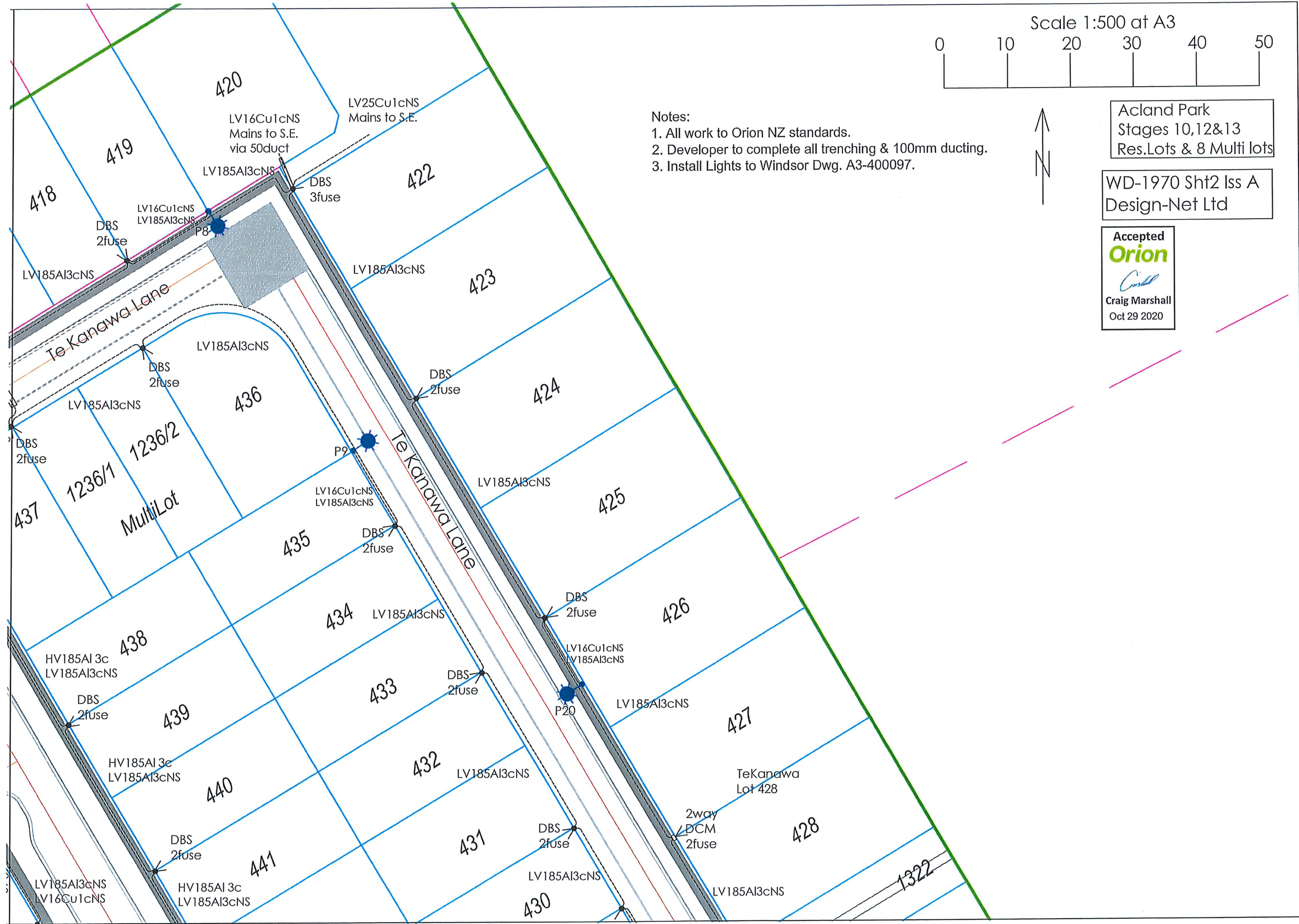



Acland Park  
Stages 10,12&13  
Res.Lots & 8 Multi lots

WD-1970 Sht3 Iss A  
Design-Net Ltd

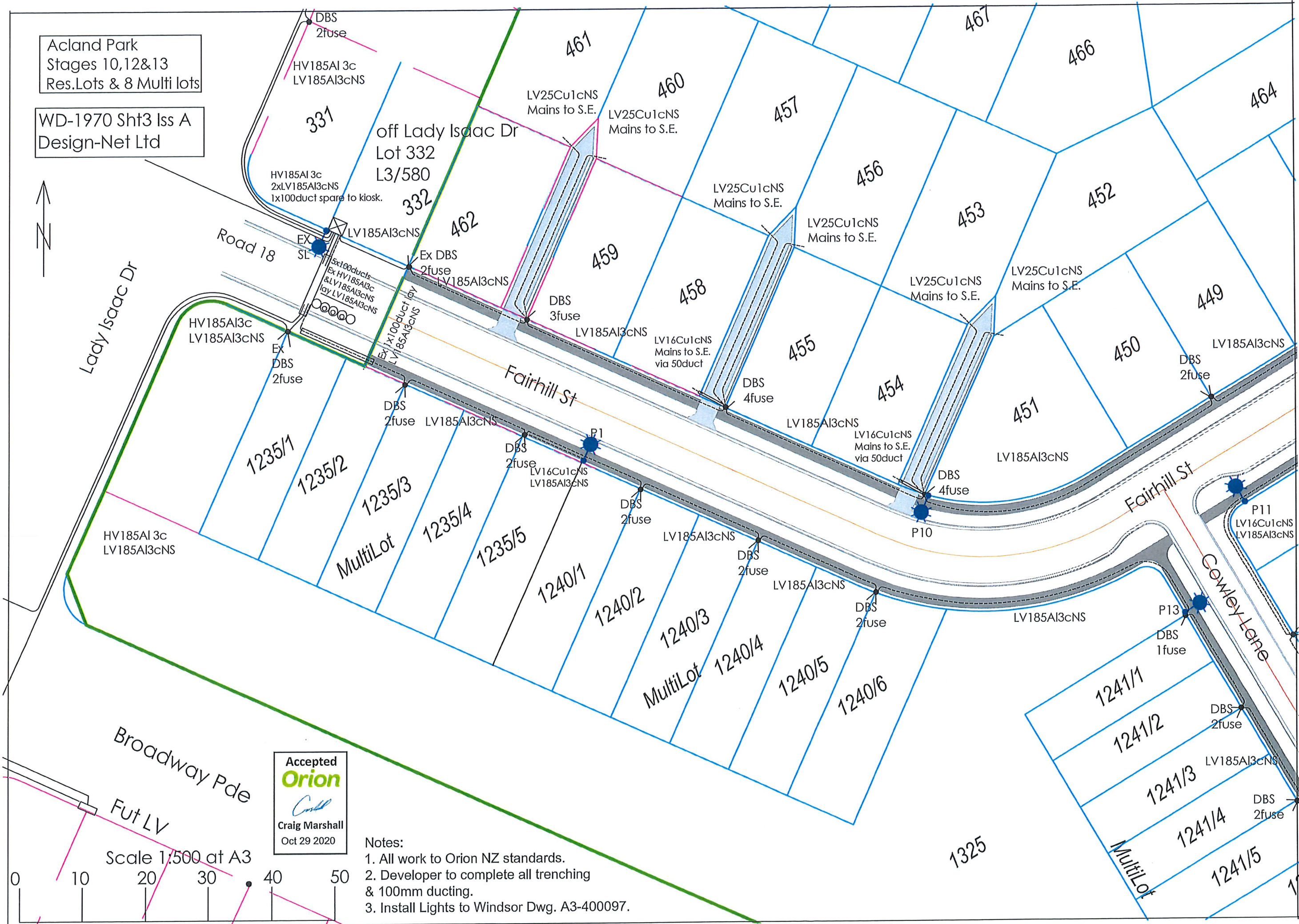







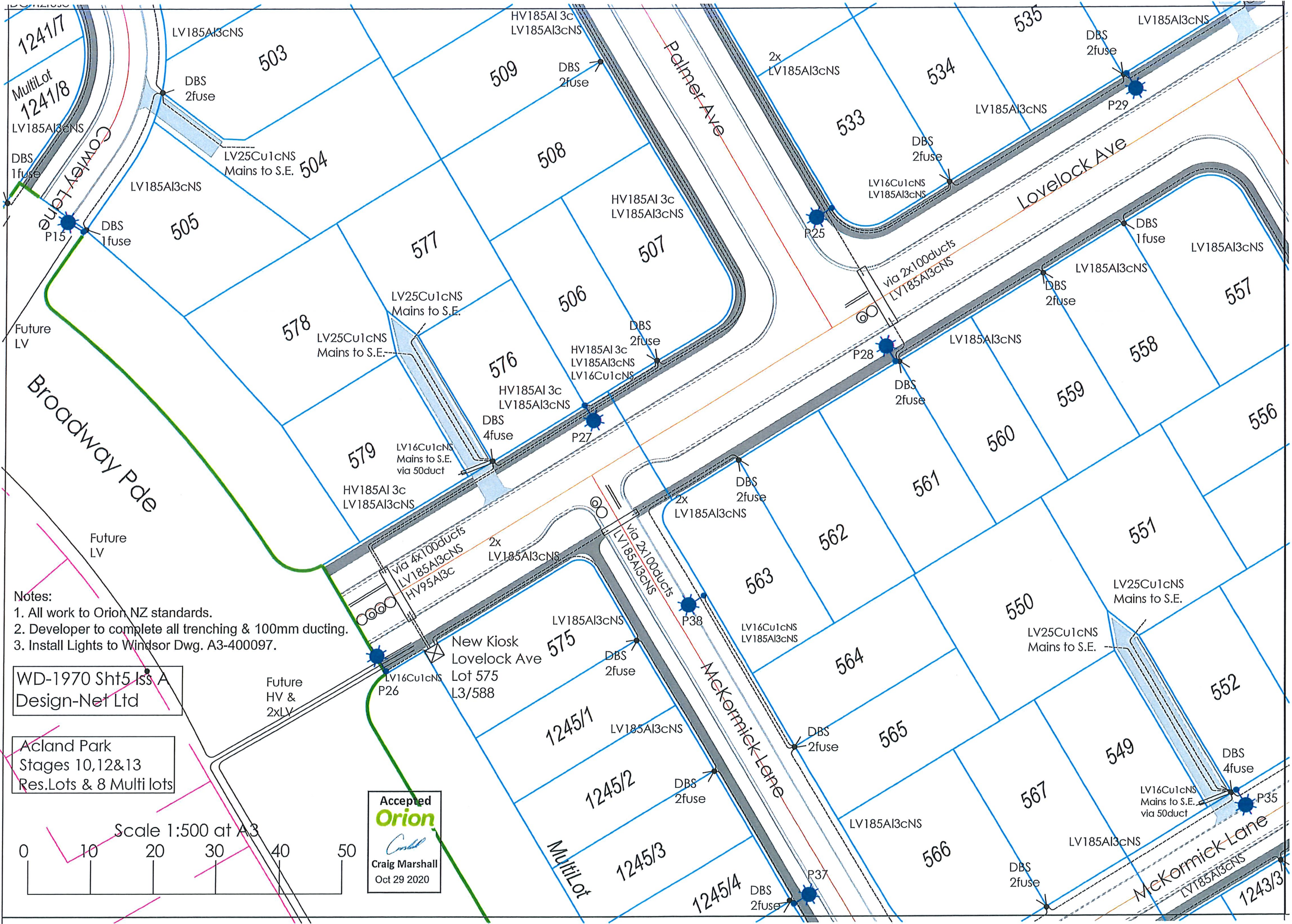

- Notes:
1. All work to Orion NZ standards.
  2. Developer to complete all trenching & 100mm ducting.
  3. Install Lights to Windsor Dwg. A3-400097.

WD-1970 Sht5 Iss A  
Design-Net Ltd

Acland Park  
Stages 10,12&13  
Res.Lots & 8 Multi lots

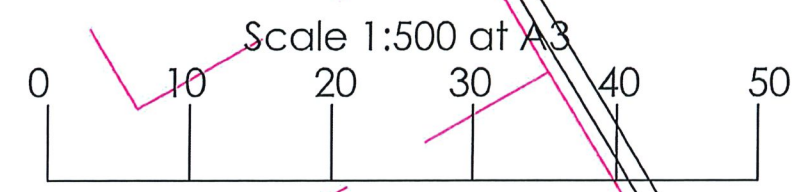

Accepted  
**Orion**  
Craig Marshall  
Oct 29 2020







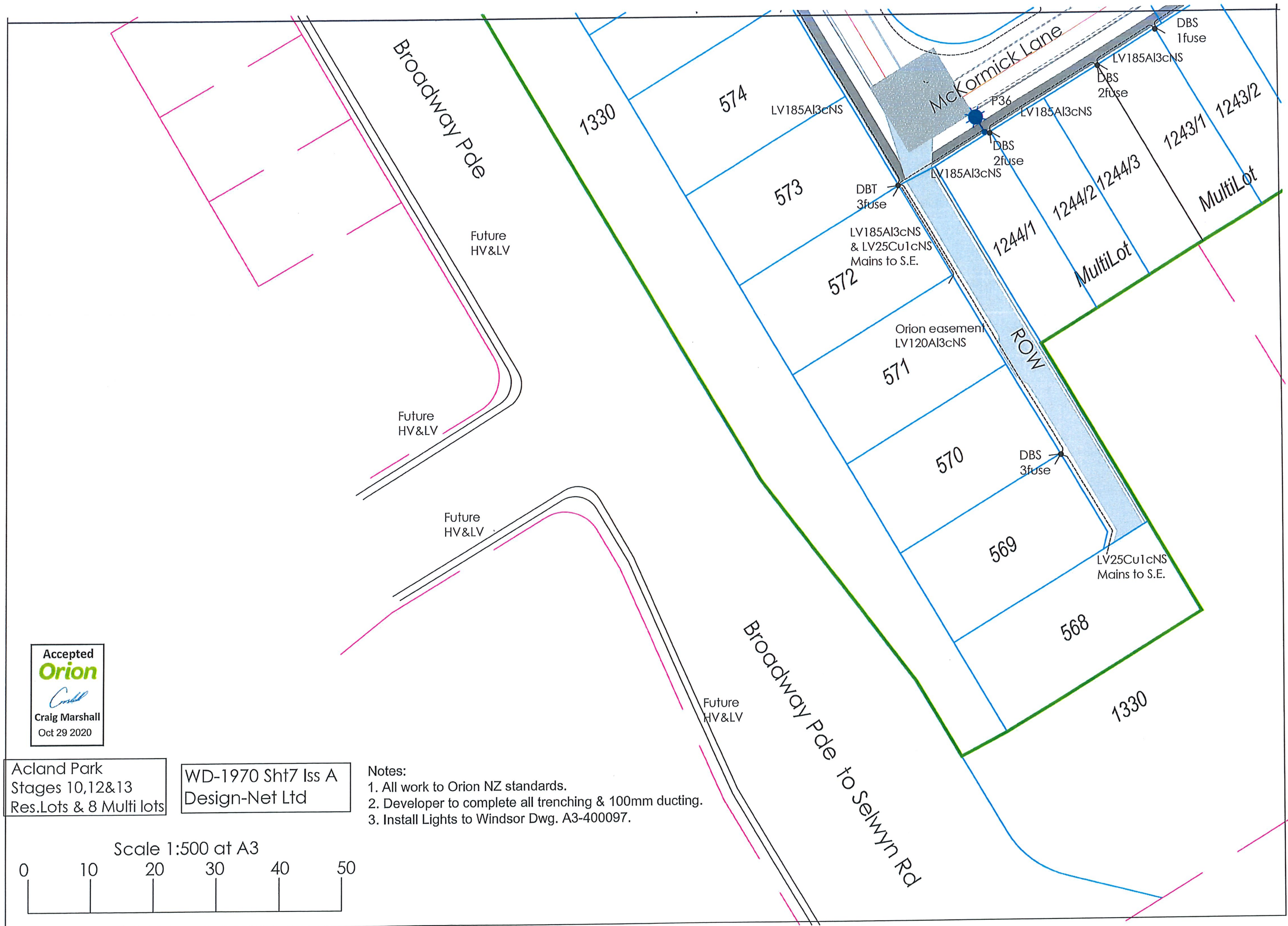

Accepted  
**Orion**  
*Craig Marshall*  
 Craig Marshall  
 Oct 29 2020

Acland Park  
 Stages 10,12&13  
 Res.Lots & 8 Multi lots

WD-1970 Sht7 Iss A  
 Design-Net Ltd

- Notes:
1. All work to Orion NZ standards.
  2. Developer to complete all trenching & 100mm ducting.
  3. Install Lights to Windsor Dwg. A3-400097.

