



- LEGEND:**
- uPVC PN12 WATER MAIN
 - 63mm OD MDPE 80B PN12.5 SUB MAIN
 - PROPOSED 25/32mm Ø WATER LATERAL
 - PROPOSED 25mm Ø WATER LATERAL WITH NO TOBY BOX
 - SV 100/150Ø SLUICE VALVE
 - GV 50Ø GATE VALVE
 - WATER MANIFOLD
 - H STANDARD HYDRANT

- NOTES:**
1. ALL WORKS TO BE CARRIED OUT IN ACCORDANCE WITH SPECIFICATION AND SDC PART 7 WATER SUPPLY.
 2. ALL MAINS TO BE uPVC PN 12, SUBMANS TO BE 6300 MDPE 80B PN 12.5.
 3. WATER MAINS TO BE 1.9m FROM BOUNDARY, OR AS SHOWN OTHERWISE.
 4. WATER PIPES IN R.O.W'S TO BE LAID IN COMMON SERVICE TRENCH AGAINST THE LEGAL BOUNDARY.
 5. SLUICE VALVES AND GATE VALVES ARE TO BE LOCATED IN BERM.
 6. MINIMUM COVER FOR MAINS WITHIN CARRIAGEWAY TO BE 750mm, AND TO COMPLY WITH "CODE OF PRACTICE FOR WORKING ON THE ROAD".
 7. DETECTOR TAPE TO BE LAID ABOVE ALL MAIN WATER PIPES.
 8. ANY LAYING OF PIPE MAINS OR CONNECTIONS TO THE EXISTING COUNCIL WATER RETICULATION SHALL BE INSPECTED BY SDC. ANY LIVE CUT TO BE SUPERVISED/STOOD OVER BY SICON.
 9. CHLORINATION IS TO BE CARRIED OUT ON SYSTEM AS DETAILED IN SECTION 8.15 OF THE SPECIFICATION.
 10. ALL MANIFOLD UNITS TO BE IN ACCORDANCE WITH SDC WS 3.08 AND CSS SD403 SHEET 2.
 11. THRUST BLOCK SIZING TO BE IN ACCORDANCE WITH NZS 4404:2010 VIS-004

ORIGIN OF LEVELS:	UG 32 (B882)
REDUCED LEVEL:	55.9078m
DATE:	LVD 1837
THE SITE DATUM IS:	ENGINEERING PEG
REDUCED LEVEL:	39.05m

REV	DATE	REVISION DETAILS	ISSUED
1	09/11/20	FOR CONSTRUCTION	CWH
B	08/10/20	FOR APPROVAL	CWH
A	14/08/20	FOR APPROVAL	CWH

PROJECT



Acland Park
RO. LESTON

CLIENT



AVANDA GROUP



SURVUS
CONSULTANTS
PLANNING + SURVEYING + ENGINEERING

4 Meadow Street, PO Box 5558, Papanui, Christchurch
 P 03 352 5599 ANSERLEY 03 314 9200
 F 03 352 5527 ASHBURTON 03 307 7021
 TOLL FREE 0508 787 887 DARRFIELD 03 318 8151

DRAWING TITLE

**WATER RETICULATION
SHEET 1 OF 4
STAGE 10 & 12**

STATUS	SCALE	SIZE
FOR CONSTRUCTION	1:500	A1

PROJECT NO	DRAWING NO	REVISION
14557	S10-EN-125	1

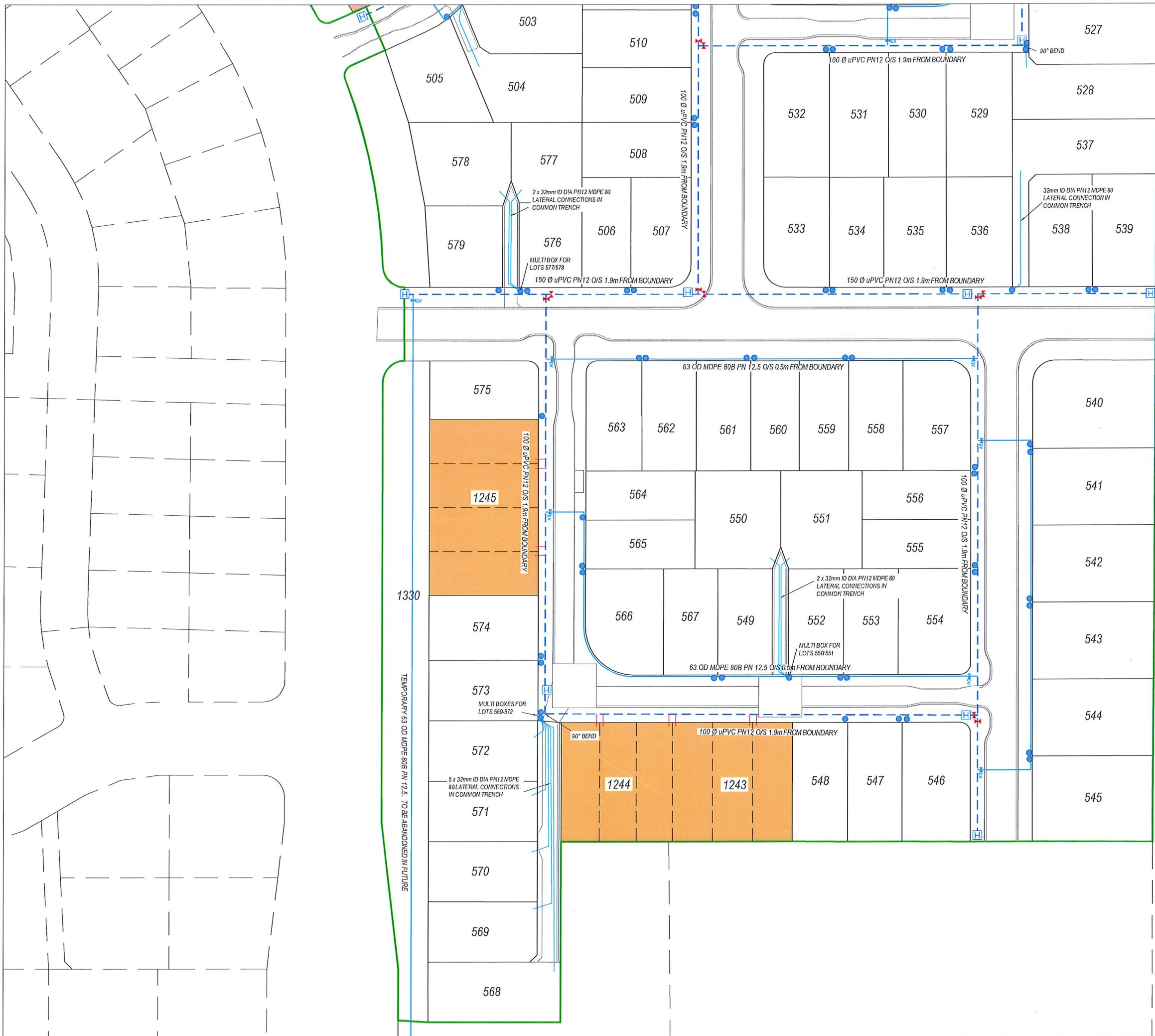

- LEGEND:**
- uPVC PN12 WATER MAIN
 - 63mm OD MDPE 80B PN12.5 SUB MAIN
 - PROPOSED 25/32mmØ WATER LATERAL
 - PROPOSED 25mmØ WATER LATERAL WITH NO TOSBY BOX
 - X 100/150Ø SLUICE VALVE
 - X 50Ø GATE VALVE
 - WATER MANIFOLD
 - H STANDARD HYDRANT

- NOTES:**
1. ALL WORKS TO BE CARRIED OUT IN ACCORDANCE WITH SPECIFICATION AND SDC PART 7 WATER SUPPLY.
 2. ALL MAINS TO BE uPVC PN 12, SUBMANS TO BE 63OD MDPE 80B PN 12.5.
 3. WATER MAINS TO BE 1.9m FROM BOUNDARY, OR AS SHOWN OTHERWISE.
 4. WATER PIPES IN R.O.W.S TO BE LAID IN COMMON SERVICE TRENCH AGAINST THE LEGAL BOUNDARY.
 5. SLUICE VALVES AND GATE VALVES ARE TO BE LOCATED IN BERM.
 6. MINIMUM COVER FOR MAINS WITHIN CARRIAGEWAY TO BE 750mm, AND TO COMPLY WITH 'CODE OF PRACTICE FOR WORKING ON THE ROAD'.
 7. DETECTOR TAPE TO BE LAID ABOVE ALL MAIN WATER PIPES.
 8. ANY LAYING OF PIPE MAINS OR CONNECTIONS TO THE EXISTING COUNCIL WATER RETICULATION SHALL BE INSPECTED BY SDC. ANY LIVE CUT TO BE SUPERVISED/STOOD OVER BY SICON.
 9. CHLORINATION IS TO BE CARRIED OUT ON SYSTEM AS DETAILED IN SECTION 8.15 OF THE SPECIFICATION.
 10. ALL MANIFOLD UNITS TO BE IN ACCORDANCE WITH SDC WS 3.0B AND CSS SD403 SHEET 2.
 11. THRUST BLOCK SIZING TO BE IN ACCORDANCE WITH NZS 4404:2010 WS-004

ORIGIN OF LEVELS:	UG 32 (B882)
REDUCED LEVEL:	55.9078m
DATUM:	LVD 1937 (JAN 2018)
THE SITE DATUM IS:	ENGINEERING PEG
REDUCED LEVEL:	39.05m

REV	DATE	REVISION DETAILS	ISSUED
1	09/11/20	FOR CONSTRUCTION	CWH
B	08/10/20	FOR APPROVAL	CWH
A	14/08/20	FOR APPROVAL	CWH

PROJECT



Acland Park
ROLESTON

CLIENT



AVANDA GROUP



SURVUS
CONSULTANTS
PLANNING + SURVEYING + ENGINEERING

4 Meadow Street, PO Box 5558, Papanui, Christchurch
 P 03 352 5599 AHSERLEY 03 314 9200
 F 03 352 5527 ASHBURTON 03 307 7021
 TOLL FREE 0508 787 887 DARFIELD 03 318 8151

DRAWING TITLE

**WATER RETICULATION
SHEET 2 OF 4
STAGE 10 & 12**

STATUS	SCALE	SIZE
FOR CONSTRUCTION	1:500	A1

PROJECT NO	DRAWING NO	REVISION
14557	S10-EN-126	1

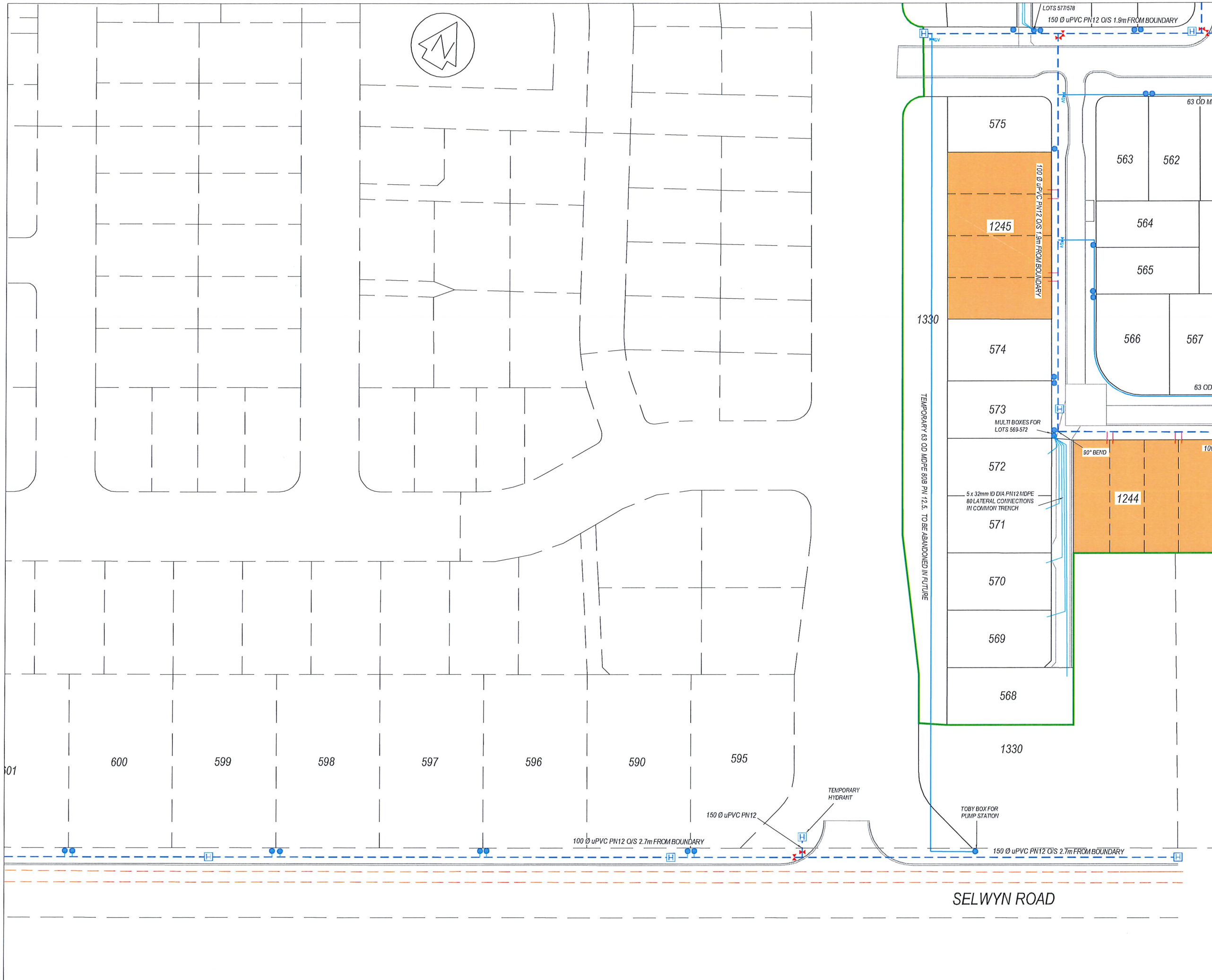

- LEGEND:**
- uPVC PN12 WATER MAIN
 - 63mm OD MDPE 80B PN12.5 SUB MAIN
 - PROPOSED 25/32mm Ø WATER LATERAL
 - PROPOSED 25mm Ø WATER LATERAL WITH NO TOBY BOX
 - 100/150 Ø SLUICE VALVE
 - 50 Ø GATE VALVE
 - WATER MANIFOLD
 - STANDARD HYDRANT

- NOTES:**
1. ALL WORKS TO BE CARRIED OUT IN ACCORDANCE WITH SPECIFICATION AND SDC PART 7 WATER SUPPLY.
 2. ALL MAINS TO BE uPVC PN 12, SUBMANS TO BE 63OD MDPE 80B PN 12.5.
 3. WATER MAINS TO BE 1.9m FROM BOUNDARY, OR AS SHOWN OTHERWISE.
 4. WATER PIPES IN R.O.W.S TO BE LAID IN COMMON SERVICE TRENCH AGAINST THE LEGAL BOUNDARY.
 5. SLUICE VALVES AND GATE VALVES ARE TO BE LOCATED IN BERM.
 6. MINIMUM COVER FOR MAINS WITHIN CARRIAGEWAY TO BE 750mm, AND TO COMPLY WITH 'CODE OF PRACTICE FOR WORKING ON THE ROAD'.
 7. DETECTOR TAPE TO BE LAID ABOVE ALL MAIN WATER PIPES.
 8. ANY LAYING OF PIPE MAINS OR CONNECTIONS TO THE EXISTING COUNCIL WATER RETICULATION SHALL BE INSPECTED BY SDC. ANY LIVE CUT TO BE SUPERVISED/STOOD OVER BY SICON.
 9. CHLORINATION IS TO BE CARRIED OUT ON SYSTEM AS DETAILED IN SECTION 8.15 OF THE SPECIFICATION.
 10. ALL MANIFOLD UNITS TO BE IN ACCORDANCE WITH SDC WS 3.0B AND CSS SD403 SHEET 2.
 11. THRUST BLOCK SIZING TO BE IN ACCORDANCE WITH NZS 4404:2010 WS-004

ORIGIN OF LEVELS:	UG 32 (8882)
REDUCED LEVEL:	55.5078m
DATUM:	LVD 1937 (JAN 2018)
THE SITE DATUM IS:	ENGINEERING PEG
REDUCED LEVEL:	39.05m

REV	DATE	REVISION DETAILS	ISSUED
1	09/11/20	FOR CONSTRUCTION	CWH
B	08/10/20	FOR APPROVAL	CWH
A	14/08/20	FOR APPROVAL	CWH

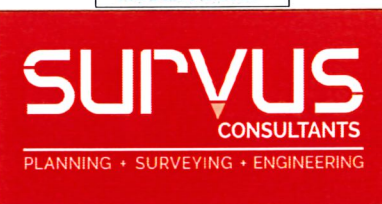

4 Meadow Street, PO Box 5558, Papanui, Christchurch
 P 03 352 5599 AMBERLEY 03 314 9200
 F 03 352 5527 ASHBURTON 03 307 7021
 TOLL FREE 0508 787 887 DARFIELD 03 318 8151

DRAWING TITLE

**WATER RETICULATION
SHEET 3 OF 4
STAGE 10 & 12**

STATUS	SCALE	SIZE
FOR CONSTRUCTION	1:500	A1

PROJECT NO	DRAWING NO	REVISION
14557	S10-EN-127	1